

# 16" TABLE FAN USER MANUAL

## MODEL: MTF1603

### WARNING AND RULES FOR SAFE OPERATION

1. Never insert fingers, pencils or any other object through the fan guards when the fan is running.
2. Unplug the fan when moving it from one location to another.
3. The fan guard is not allowed to be removed during cleaning.
4. Unplug the fan when removing fan guards for cleaning.
5. **DO NOT** use the fan in the window; rain may create electrical hazard.
6. **DO NOT** leave the fan running unattended.
7. Keep electrical appliances out of reach from children or infirm persons. Do not let them use the appliances without supervision.
8. Ensure that the fan switched off from the supply mains before removing the guard.
8. If the supply cord is damaged, it must be replaced by manufacturer, or its service agent, or a similarly qualified person in order to avoid hazard.
10. This appliances is not intended for use by persons (including children) with reduced physical, sensory or mental capabilities, or lack of experience and knowledge, unless they have been given supervision or instruction concerning use of the appliance by a person responsible for their safety.
11. Children should be supervised to ensure that they do not play with the appliance.
12. The appliance is intended for household and indoor use only.

### ASSEMBLY OF FAN BODY

1. Match the fan body to the base.
2. Tighten the screw to lock the fan body & base from the bottom.

### FAN BLADE AND FAN GUARDS ASSEMBLY

1. Remove the spinner and the plastic nut from the front side of the motor. Fix the rear guard to the motor and then tighten the plastic nut.
2. Insert the blade into the motor shaft and make sure the pin is fitted into groove of the blade. Turn the spinner counter-clockwise to fasten the blade.
3. Fix both guards with plastic ring and use screwdriver to lock the screw.

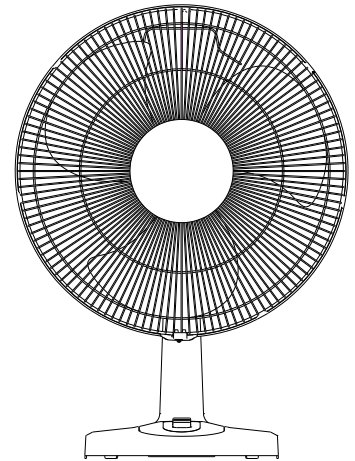
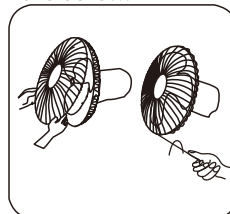
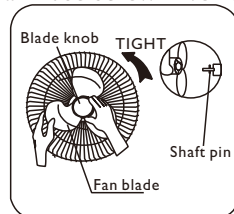
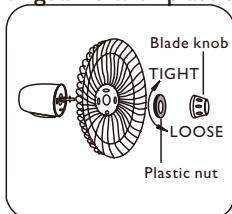

### OPERATION INSTRUCTIONS

#### 1. SPEED CHOICE

Switch on/off the fan and adjust to the desired speed by pressing the speed buttons: 0 - Stop 1 - Low 2 - Medium 3 - High

#### 2. OSCILLATION

Press the OSC knob on back of the motor; the fan will operate with auto-oscillation from left to right. Pull the OSC knob up, the oscillation will stop.

#### 3. TILT ADJUSTMENT

To adjust the air flow upward or downward, push the fan guard lightly to the desired direction.

### OVERHEATING PROTECTION OF THE MOTOR

In case that the motor is overheated for any unexpected reason, the thermal-fuse attached on the windings of the motor will burn out to switch off the fan, and the temperature of the motor is no longer going up so that plastic parts of the fan won't be deformed or burned by the overheating.

### CLEANING

1. Be sure to unplug the fan from the electrical supply mains before cleaning.
2. Plastic parts should be cleaned with a soft cloth moisten with mild soap. Thoroughly remove soap film with dry cloth.

**DISPOSAL:** Do not dispose of electrical appliances as unsorted municipal waste, use separate collection facilities. Contact your local government for information regarding the collection systems available. If electrical appliances are disposed of in landfills or dumps, hazardous substances can leak into the groundwater and get into the food chain, damaging your health and well-being.

