

mistral

Blade Free Fan with Air Purifier MBFAP500

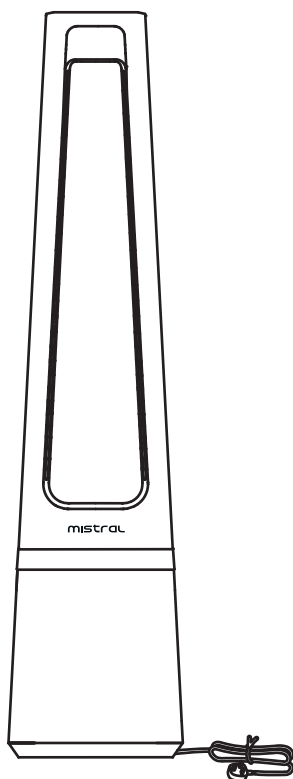

BLADELESS FAN

Please read this instruction manual thoroughly before operating and keep it for future reference

IMPORTANT SAFETY INSTRUCTIONS

Warning

- This appliance is not intended for use by individuals with reduced physical, sensory, or mental capabilities, or those who lack experience and knowledge unless they have been given supervision or instruction by a person responsible for their safety.
- Children should be supervised at all times while in use.
- Do not use the appliance if the cord or plug is damaged, if the appliance has malfunctioned, or if it has been dropped or damaged in any way. If the power cord is damaged, it should be replaced by the Service Centre to avoid any hazards.
- Always follow basic safety precautions when using electrical appliances to reduce the risk of fire, electric shock, and/or injury.
- Do not immerse the appliance, power cord, or power plug in water or any other liquid.
- Always unplug the appliance from the outlet when not in use and before cleaning.
- Never unplug the appliance by pulling on the cord.
- Only use accessories that come with the appliance, as other accessories may cause fire, electric shock, or injury.

Bladeless Fan Safety Instructions

- It is recommended to switch off the product, and allow the motor to rest for at least 1 hour after 15 hours of use.
- For your own safety, please clean the product regularly. Accumulation of dust/ pet dander etc. may lead to motor failure or pose a fire hazard. Ensure that the product is switched off when cleaning.
- Do not move the fan when it is connected to the power supply.
- Do not stretch or energize the cable. Keep the cable away from the heat source.
- Do not run the cable under carpets, do not cover it with carpets or any other similar covers.
- Route the cable away from the walking area to avoid tripping over by the power cord.
- Turn off all controls before pulling the plug, and pull the plug out of the socket if you are not going to use the device for a long time.
- Do not place any objects on/cover the air inlet or outlet.
- Make sure that the ventilation openings are free of dust, lint, hair or any other obstacles that could impair the air flow in/out.
- The fan should be set up dry on a horizontal platform and should not be near heat sources, corrosive air and moisture.
- The fan should be kept a distance of 150mm around to ensure good air circulation.
- Do not use the fan outdoors or on a wet surface.
- Please do not use any Air freshener or similar products close to the fan.
- Do not use any cleaning agents or lubricants for this fan.

PRODUCT TECHNICAL PARAMETERS

MODEL	RATED VOLTAGE	RATED POWER	AIR VOLUME	MAX AIR FLOW
MBFAP500	220-240V ~ 50Hz	33W	20 m ³ /min	120 m/min

INTRODUCTION OF PARTS

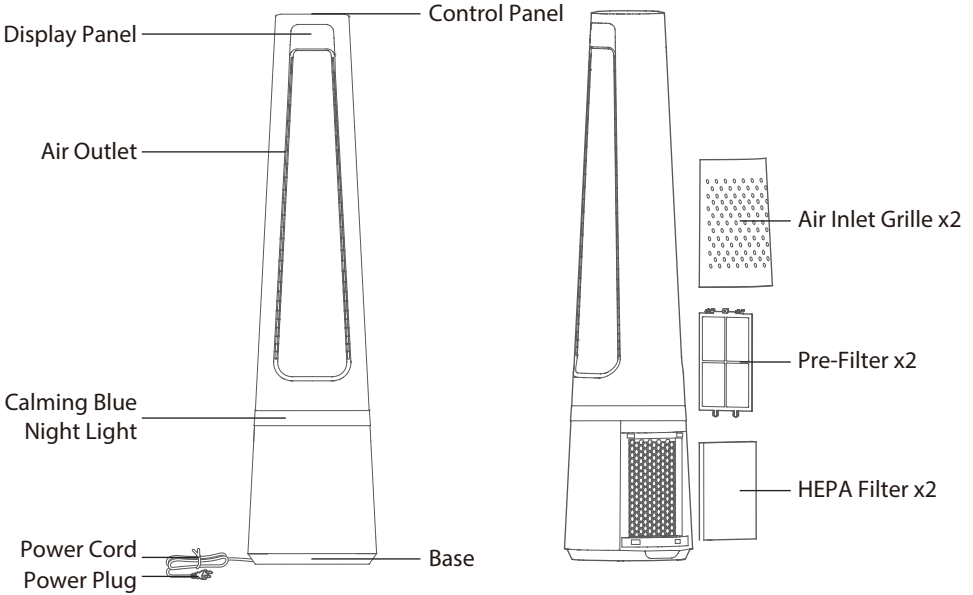

Remote Control

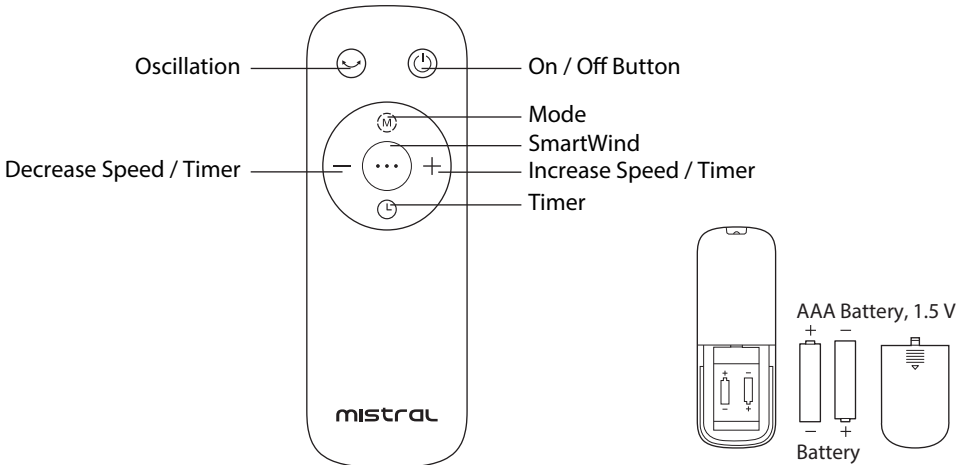

CONTROLS AND OPERATIONS

Setting up the appliance:

1. Carefully remove the air inlet grille.
2. Take out the pre-filter. Press the raised part on both sides to pull it outwards, and take out the pre-filter.
3. Remove the protective film of the filter.

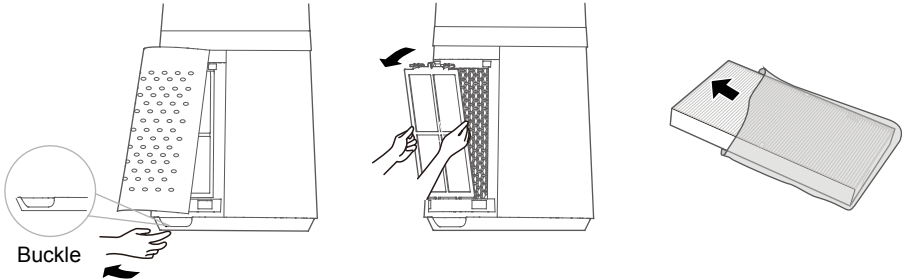

4. Place the HEPA filter.
5. Place the pre-filter in, make sure to align the slot position at the bottom, and buckle up the upper U-shaped buckle.
6. Place the air inlet grille and align the upper two buckles and press them tightly, then press the two sides at lower part, slowly and gently buckle the air inlet grille.
7. Plug in the power plug supply and press the ON / OFF button to power on.

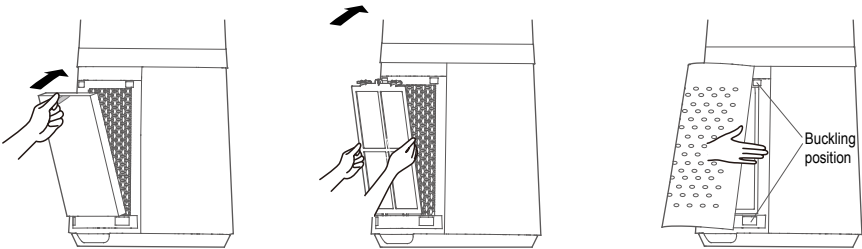

Note:

- It is recommended to clean the filter once every two weeks and replace it once every six months (the cleaning and replacement cycle can be adjusted according to the use environment).

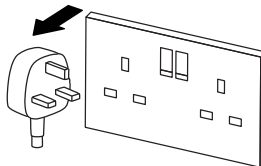

Control Panel

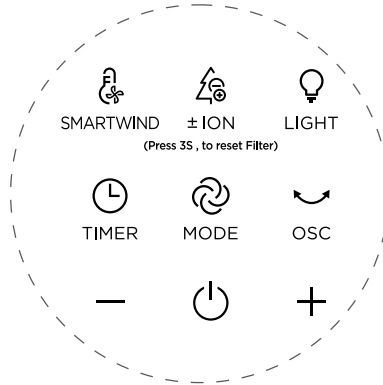

Display Panel

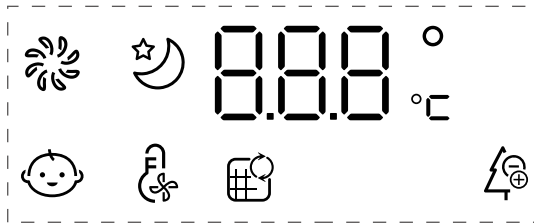

Operation:

Power

- Check the household voltage to ensure it matches the appliance's rated specification. Be sure to plug into a 220-240V ~ 50Hz outlet.
- Put in the plug, you can hear a beep, and the LED display show the room temperature, then press the ON / OFF button "⏻" to start.

Speed:

- 12 speeds can be adjusted by pressing the speed buttons "+" to increase and "-" to decrease, when you chose a speed, the number will show in the display window, after few second, the speed number will be fixed.





Oscillation:

- Press the "↔", the product will oscillate left and right by automatic, it is adjustable to 30°, 60°, 120° and 0°
- Automatic reset of oscillating function upon shutdown
- Upon shutdown, the oscillating function is automatically reset.

Memory function

- When the fan is turned off or powered off, it will run in the state before turning off or power off when the power is powered on again (the timing function is not memorized).

Mode:

- Press the "  ", and the LED display panel will show the fan speed and the mode.
- Normal mode "  " with 12 fan speeds, Baby mode "  " with 2 fan speeds, Sleep mode "  " with 2 fan speeds.

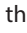

Timer:

- Press the "  ", and the LED display window will show the timer hours number, and the Indicator light will on.
- The timer can be adjusted by pressing "+" to increase and "-" to decrease the hours.

Smartwind

- Press the "  " and it will change the speed of the fan to adjust according to environment temperature.

Ion

- Press the "  " to turn on/off the ion sterilization mode.
Press and hold for 3 secs the "  " to reset the filter.

Auto Shutdown

- There is no operation during the running of the fan, after 12 hours of continuous operation, the fan will automatically shut down.

Screen-off function

- The indicator light on the body will be automatically switch off after 60 seconds, but the fan will continue to operate. Press the ON/OFF button to turn off the fan, and press the other button to restore display.

Lighting

- Press the "  " to turn on/off the calming blue night light.

Remote Control:

- The remote control can be used at an angle of approximately 45°, within a distance of up to 5 meters.
- The battery contains many heavy metals, acids and bases, etc., which may threaten human's health; Waste batteries should be recycled separately.
- Use manganese or alkaline batteries of type "AAA". DO not use rechargeable batteries.

CLEANING AND MAINTENANCE

Cleaning the Filter

1. Unplug the power cord.
2. Carefully remove the cover and take out the filter.
3. Remove the dust with a vacuum cleaner.
4. Place the filter back, push the cover back in, and plug in the appliance.

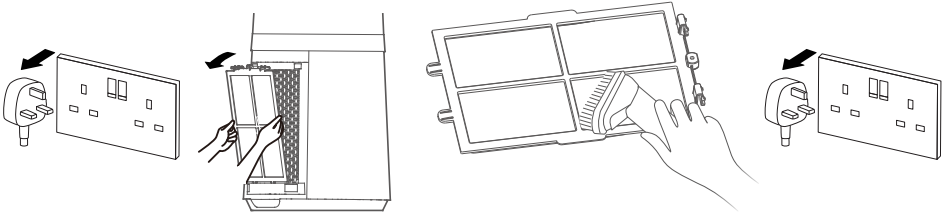

When to replace the filter

1. When the indicator light “” for replacement of filter is on, the prompt that reminds you of filter replacement will appear. If it is not replaced in time, the prompt will appear during each startup.
2. Replace a new filter by carefully remove the cover and take out the filter, then place the new filter in and push the cover back in.
3. Long press the net ion button for 3 seconds to turn off the indicator light for filter replacement.

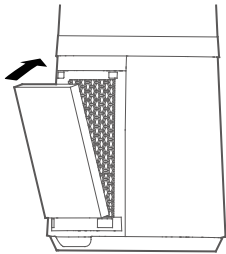

± ION

(Press 3S , to reset Filter)

Warranty & Customer Service

SCAN FOR



e-Warranty

e-Warranty Registration at www.mayer.sg

MAYER MARKETING PTE LTD

Customer Service Hotline: 6542-8383 (Mon - Fri 9:00am to 5:00 pm)

Service Centre Operating Hours:

Mon - Fri: 9:00am to 5:00pm

Sat: 9:00am to 12:00pm

Closed on Sunday & Public Holidays

71 Ubi Crescent, #06-02, Excalibur Centre, Singapore 408571.