

mistral

16" DC Stand Fan with Remote MIF407R

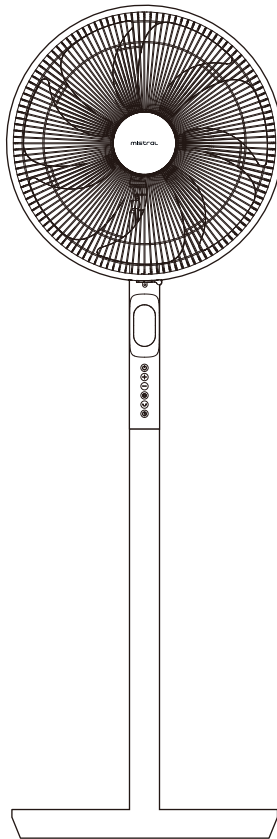

STAND FAN

Please read this instruction manual thoroughly before operating and keep it for future reference

IMPORTANT SAFETY INSTRUCTIONS

Warning

- This appliance is not intended for use by individuals with reduced physical, sensory, or mental capabilities, or those who lack experience and knowledge unless they have been given supervision or instruction by a person responsible for their safety. Children should be supervised at all times while in use.
 - Do not use the appliance if the cord or plug is damaged, if the appliance has malfunctioned, or if it has been dropped or damaged in any way. If the power cord is damaged, it should be replaced by the Service Centre to avoid any hazards.
- Always follow basic safety precautions when using electrical appliances to reduce the risk of
- fire, electric shock, and/or injury.
 - Do not immerse the appliance, power cord, or power plug in water or any other liquid.
 - Always unplug the appliance from the outlet when not in use and before cleaning.
 - Never unplug the appliance by pulling on the cord.
 - Only use accessories that come with the appliance, as other accessories may cause fire, electric shock, or injury.

Stand Fan Safety Instructions

- It is recommended to switch off the stand fan and allow the motor to rest for at least 1 hour after 15 hours of use.
- For your own safety, please clean your stand fan regularly. Accumulation of dust/ pet dander etc. may lead to motor fire or pose a fire hazard.
- When the appliance is not in use and before cleaning, unplug the appliance from the outlet.
- Indoor and household use only.
- When the fan was assembled, the rotor blade guard shall not be taken off anymore.
 - Before cleaning unplug the fan.
 - The rotor guard shall not be dissembled/opened to clean the rotor blades.
 - Wipe the fan enclosure and rotor blade guard with a slightly damp cloth.
- Never insert fingers, pencils, or any other object through the grille when the fan is running.
- Disconnect fan when moving from one location to another.
- Be sure the fan is on a stable surface when operating to avoid overturning.
- Do not use the fan near the window, rain may create an electrical hazard.
- Do not use the fan near or in wet or damp locations. Never place the FAN where it may fall into a bathtub or other water container.
- Avoid using extension cord as the extension cord may overheat and cause a risk of fire.
- Ensure that the fan is switching off from the supply mains before removing the guard

PRODUCT TECHNICAL PARAMETERS

MODEL	RATED VOLTAGE	RATED POWER
MIF407R	220-240V~ 50/60Hz	29W

INTRODUCTION OF PARTS

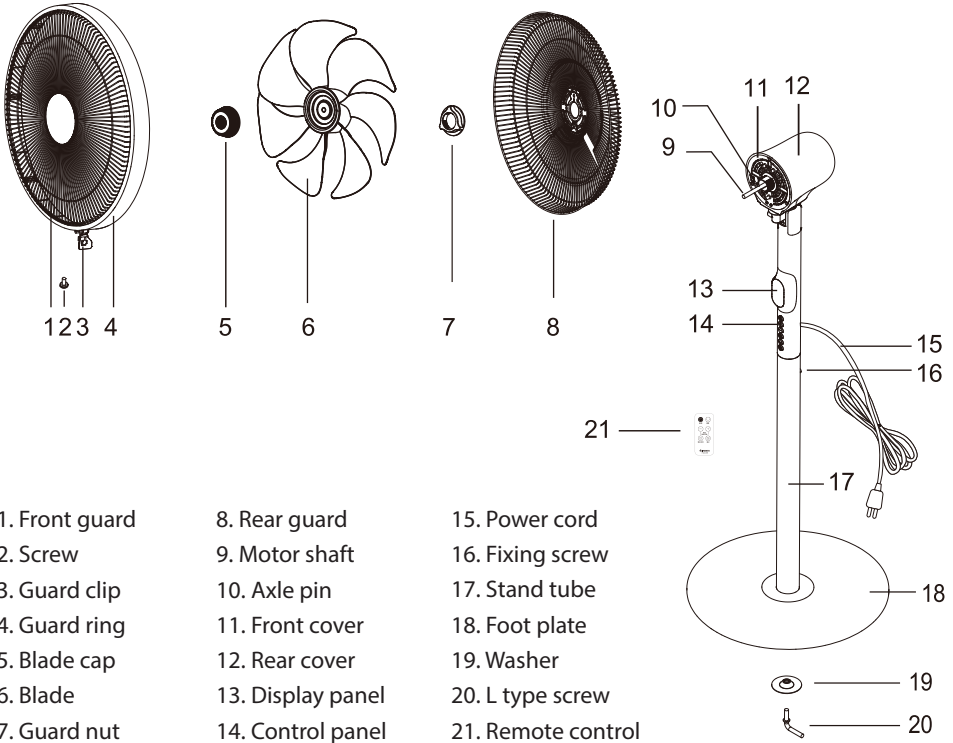

CONTROLS AND OPERATIONS

Assembly

- When using, please assemble correctly according to the following order.
- Do not insert the power plug into the socket before assembly is completed to avoid danger.
- Please keep the packaged items in a safe place for use in storage.

Foot plate and riser tube assembly method

1. First remove the L-shaped screw and the fixing iron plate under the riser tube in the counterclockwise direction.
2. Then insert the stand pipe into the center hole of the foot plate.
3. Align the L-shaped screw with the center hole of the fixed iron plate and lock the riser pipe clockwise from the raised part of the fixed iron plate to the hole of the foot plate.

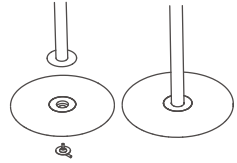

Method for assembling body assembly and riser pipe

1. Use a flat-head screwdriver or turn counterclockwise the flat-head screw that fixes the riser pipe.
2. Align the body assembly with the riser pipe and insert it according to the following figure
3. Tighten the slotted screw clockwise and fix it firmly.

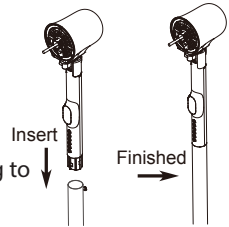

Rear guard assembly method

1. As shown in the figure on the right, first remove counterclockwise the guard nut which fixed on the front housing of the motor, align the two grooves of the rear guard with the two bumps in front of the motor, and turn the guard nut clockwise tightly.

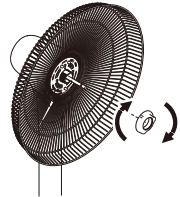

Blade assembly method

1. Insert the blade into the motor shaft center as shown in the figure on the right. The groove on the back of the blade aligns with the shaft center and the pin is pressed to the bottom. The blade cap must be aligned with the motor shaft center, and be tightened counterclockwise.

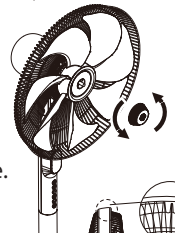

Front guard assembly method

Hang the hook of the front guard directly above the rear guard, insert the guard circle into the rear guard so that the front and rear guards are completely consistent, press the fixed net clip under the front net circle to buckle the rear guard, and lock the net clip screw.

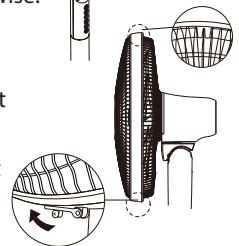

Front Guard Removal Method

1. First use a flat-blade screwdriver to pull the screw.
2. Please open the guard clip in the direction of the arrow marked by icon 1 on the right.
3. Please open the guard ring in the direction of the arrow according to the icon in Figure 2, open the guard ring in the direction of the line according to icon 3, and remove the front guard.

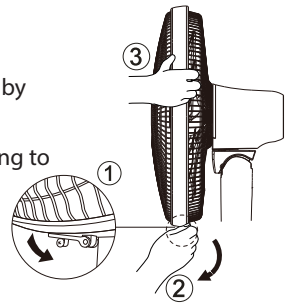

Notes:

- If you need to remove the front net, please turn off the power and pull the plug out of the socket to avoid danger.

Operating Instructions

- The fan has a memory function. When the fan is powered on, it can record the rest of the working status except for the timing and sleep functions before the last time it is turned on.
- If you need to erase the memory, just pull the power plug out of the socket to erase the memory.
- This fan is equipped with an automatic screen off function, which automatically turns off the screen without any operation in 45 seconds. If you need to wake up, you can turn it on with one button.
- The fan is equipped with a buzzer prompt device ("beep" sound prompt).

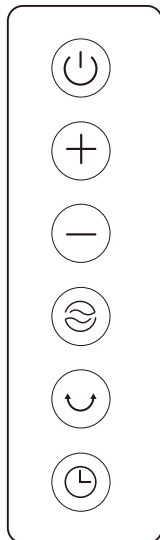

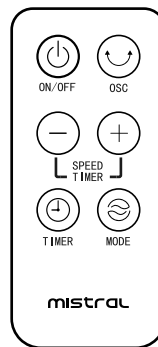

Control panel





Remote control

On/Off 

- In the power-on state, press the ON/OFF key to start the fan.
- When the fan is set to start at 16 gears when it is turned on for the first time, the buzzer will simultaneously emit a "beep beep" tone, indicating that the fan has entered the working state. If the fan is always powered on, it will automatically remember the gear set when it was turned off last time.

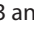
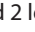
Air Volume  

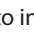
- The fan is set with 3 and 2 levels of air volume. Press the button  and button  on the control panel to increase and decrease the air volume when the fan is turned on. The buzzer will sound a "beep" sound according to the increase or decrease of the air volume. The air volume is as shown in the figure below. Cycle changes. When it is turned on again, press the button  to increase the air volume, and press the button  to decrease the air volume.

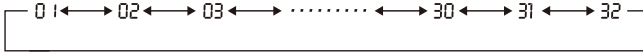



Mode 

- The fan is set to have three modes: natural, sleep, and AI smart. Press the mode button, and the mode sequence will change cyclically as shown in the figure below.



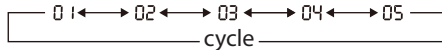

Nature 

- The natural mode is to simulate the blowing effect of the natural wind. In the natural mode, press the mode button  to select the natural mode. The natural wind speed is divided into 1~5 levels. When the power is on, press the button  and button  on the control panel. Increase the wind volume and weaken the wind speed. The wind speed changes cyclically as shown in the figure below.

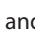

Sleep 

- Sleep mode is to simulate the comfortable blowing effect needed in sleep to help you fall asleep. In sleep mode, press the mode button  to select the sleep mode. The sleep wind is divided into 1 to 5 levels. When the power is on, press the button  and button  on the control panel can increase the wind speed and weaken the wind speed, the wind speed will change cyclically according to the icon in the figure below. When starting the sleep wind setting, it is the same as the natural wind mode, and it will automatically decrease by one gear every half an hour until it drops to the lowest natural wind.

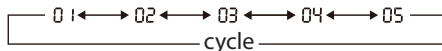

Natural wind and sleep wind 1~5 mode chart

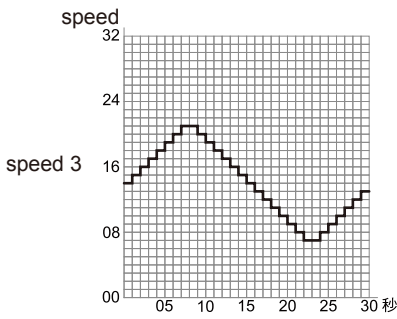
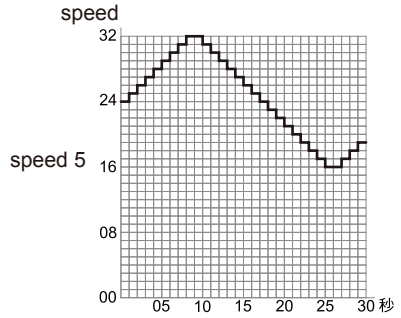
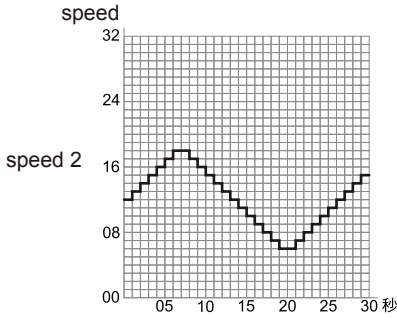
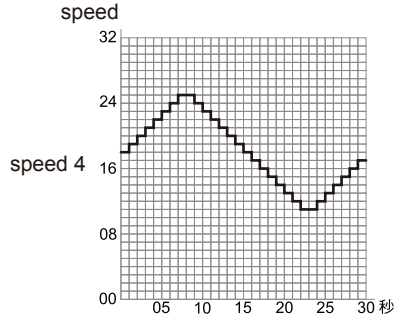
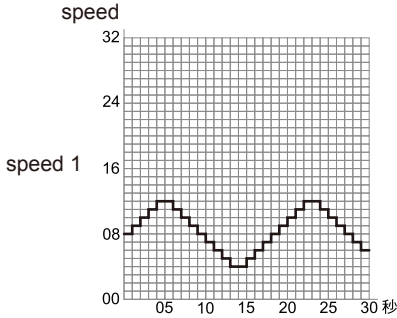





Intelligent

Start operation with the air volume set before entering the intelligent mode (or the air volume set by the user) corresponding to the current ambient temperature. When the ambient temperature drops or rises by 1°C, the air volume automatically or rises by 2 levels, and the air volume rises as the temperature rises. When the temperature reaches the highest gear, the gear will not be upshifted. When the temperature drops to the lowest gear, the gear will not be downshifted. When you press the mode button to exit the intelligent mode, the air volume will default to the current operating air volume.

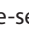

Pre-set / Timer

Power-on state use:

- The fan can be set to be turned on for 15 hours, and the mode, air volume, and head swing can be set at the same time. In the power-off state, press the Pre-set/Timer button and then press the button  and button  on the control panel to increase the boot time and decrease the boot time. The scheduled boot time changes cyclically as shown in the figure below. In the off state, the remote control operation can increase the appointment time by pressing  . Pre-set/Timer, and pressing  . Pre-set/Timer may decrease the appointment time.

Timer/ Power-off

Power-on state use:

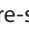
- The fan can be set to be power-off for 15 hours, and the mode, air volume, and head swing can be set at the same time. In the power-on state, press the Timer/ Power-off button and then press the button  and button  on the control panel to increase the power-off time and decrease the power-off time. The scheduled power-off time changes cyclically as shown in the figure below. In the power-on state, the remote control operation can increase the power-off time by pressing  . Pre-set/Timer, and pressing  . Pre-set/Timer may decrease the power-off time.



Oscillation

- In the power-on state, press this key to set whether the head swing can work or not.

Note: The left and right rotation is electronically controlled by the control panel and remote control. Do not manually adjust the starting angle, which may cause the synchronous motor failure.

Remote Control Battery Replacement Method And Precautions

- 1. This machine uses a (CR2032 3V) battery. Turn the back of the remote control towards you, press in the direction of arrow 1 and pull out the battery box in the direction of arrow 2, and correctly position the battery according to Figure 3 to position the positive side of the battery facing you. , And then close the battery cover in the direction of the arrow in Figure 4. Note: Please install the battery correctly. When the remote control cannot be used, please check whether the battery is installed in the correct way.

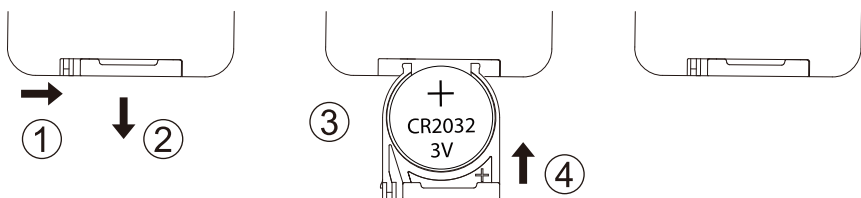

Remote Control Battery Replacement Method And Precautions

- When not in use for a long time, please take out the lithium battery and store it separately.
- Do not charge or bring the remote control close to a fire source.
- Do not place the remote control in direct sunlight or a place where the temperature is higher than 60 degrees.
- Do not place the remote control in water or humid places.
- When the lithium battery cannot be used, remove it immediately.
- Do not drop the remote control or subject it to impact.
- The remote control can be stored in the storage place on the foot plate to avoid loss.
- The best remote control distance of the remote control is within 3 meters.
- Do not disassemble, knock or modify the battery, otherwise it will easily cause the remote control to short-circuit and cause danger.
- Please point the transmitter part of the remote control at the receiver part of the main body and operate it in a direction other than the receiver part, it will not operate.
- If there is an obstacle between the transmitter part of the remote control and the receiver part of the main body, it may not operate.

Angle Adjustment Instructions

Note: The left and right oscillation are electronically controlled and can only be activated by the control panel and remote control. Please do not manually adjust the rotation angle to avoid malfunction of the internal synchronous motor.

Pitch angle adjustment:

- Pull or press down the handle of the motor front shell directly to control the up and down adjustment of the pitch angle.

Swing head adjustment:

- Press the swing head button, and the fan starts to swing its head left and right.
- Press the swing head button again, and the fan stops swinging its head left and right.

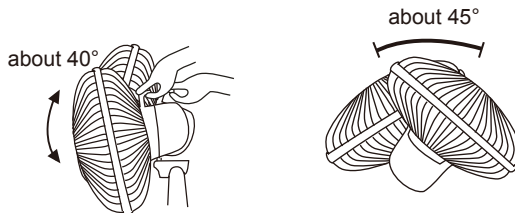

CLEANING AND MAINTENANCE

Maintenance

The fan requires little maintenance. Do not try to fix it by yourself. Refer it to qualified service personnel if service is needed.

1. Before cleaning and assembling, fan must be unplugged.
2. To ensure adequate air circulation to the motor, keep vents at the rear of the motor free of dust. Do not disassemble the fan to remove dust.
3. Please wipe the exterior parts with a soft cloth soaking a mild detergent.
4. Do not use any abrasive detergent or solvents to avoid scratching the surface. Do not use any of the following as a cleaner: gasoline, thinner.
5. Do not allow water or any other liquid into the motor housing or interior parts.

Cleaning

1. Be sure to unplug from the electrical supply source before cleaning.
2. Plastic parts should be cleaned with a soft cloth moisten with mild soap. Thoroughly remove soap film with dry cloth.

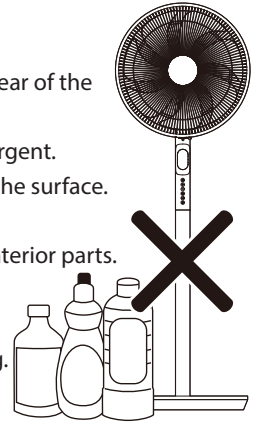

TROUBLESHOOTING

Problem	Cause of Issue	Solution
The fan blades are not running when the fan starts.	Is the power cord plug really inserted into the socket, and check if it is loose?	Please make sure that the power plug is inserted into the socket.
	Is the fan net deformed and the fan blade touches the fan blade?	Please adjust the deformed part of the fan net.
The fan does not work when the remote control is in use.	Is the remote control pointed at the receiving piece of the stand remote control, or is there a foreign object blocking the reception?	Please aim the remote control at the receiving part of the foot stand and remove obstructions.
	Please check whether the remote control battery is installed correctly?	Please install the battery correctly or replace the battery.
	Is the remote control distance more than 3 meters?	The best remote control distance is within 3 meters, please adjust the remote control distance.
There is a strange sound when the fan starts.	Are the fan blades actually installed in the motor shaft center?	Please confirm whether the groove on the back of the fan blade is completely consistent with the pin of the motor shaft.
	Is the fan net deformed or touching the fan blades?	Please adjust the deformed part of the fan net.
	Check whether the fan assembly is assembled in the correct position?	Please re-install the loose or un-installed part to the position.

- If the fault situation is not as described in the above table, please unplug the power plug immediately and contact the dealer or the company.
- Please do not disassemble, disassemble and modify by yourself.