

# mistral

## Electric Table Fan MTF1217SE

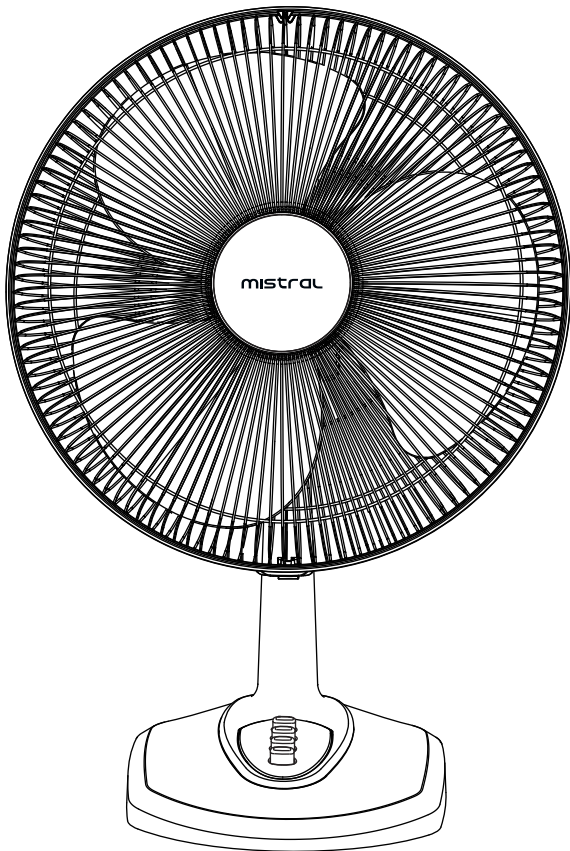

Please read this instruction manual thoroughly before operating and keep it for future reference

## IMPORTANT SAFETY INSTRUCTIONS

- This appliance is not intended for use by persons (including children) with reduced physical, sensory or mental capabilities, or lack of experience and knowledge unless they have been given supervision or instruction concerning the use of the appliance by a person responsible for their safety.
- Children should be supervised to ensure that they do not play with the appliance.
- Do not operate any appliance with a damaged cord or plug or after the appliance malfunctions, or has been dropped or damaged in any manner. If the power cord is damaged, it must be replaced by the Service Centre to avoid a hazard.
- When using electrical appliances, basic safety precautions should always be followed to reduce the risk of fire, electric shock, and/or injury.
- Do not immerse appliance, cord or plug in water or other liquid.
- Unplug from the outlet when not in use and before cleaning.
- Do not unplug the appliance by pulling on the cord.
- Use the accessories from the appliance only, as other accessories not from the appliance may cause fire, electric shock or injury.
- Use this appliance in dry places, avoid usage in excessive heat, humidity, or water.
- Avoid contacting moving parts. Keep hands, hair, and clothing away from the blade during operation to reduce the risk of injury to persons and/or damage to the fan.
- Do not use the appliance horizontally.
- Do not use the appliance where it may be exposed to flammable gas or near sources of flame such as gas rangers.
- Avoid exposing the appliance to rain or water.
- Avoid placing the appliance under direct sunlight or wind driven rain.
- Do not use the appliance other than its intended use.

## PRODUCT TECHNICAL PARAMETERS

MODEL	RATED VOLTAGE	RATED POWER	AIR VOLUME
MTF1217SE	220-240V~, 50Hz	40W	42 m <sup>3</sup> /min

## INTRODUCTION OF PARTS

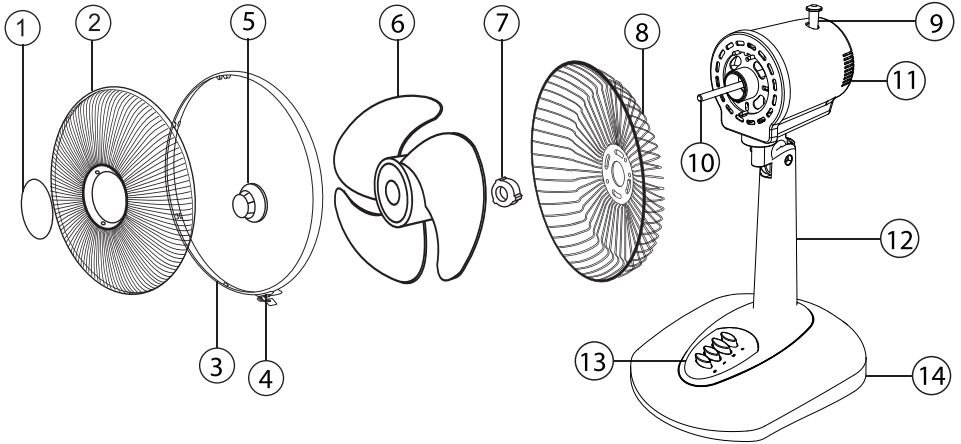

1. Guard Ornament
2. Front Guard
3. Guard Ring
4. Guard Clip
5. Spinner

6. Fan Blade
7. Rear Guard Lock
8. Rear Guard
9. Oscillation Knob
10. Motor Shaft

11. Motor Assembly
12. Fan Body
13. Control Panel
14. Plastic Pedestal

# CONTROLS AND OPERATIONS

Before use

1. Unpack all the parts from the carton.
2. Ensure the power cord passes through the hole on the back of the plastic pedestal.
3. Slot the fan body firmly into the plastic pedestal accordingly.
4. Use both palms to press the fan body surface as shown until you hear two click sounds.
5. Press the head clip inward as shown in the diagram and pull out the fan blade from the fan blade clip.

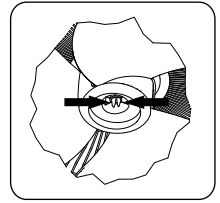
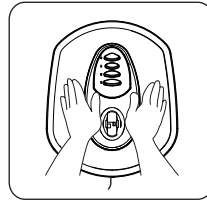
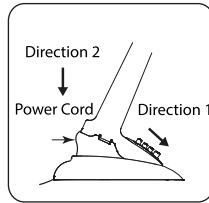
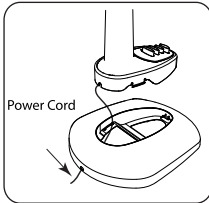

6. Remove the fan blade clip from the rear guard by pressing the clip inward.
7. Fix the rear guard to the motor assembly by matching the holes of the rear guard to the three round pins on the front of the motor assembly. Fasten the rear guard lock by turning it clockwise direction.
8. Insert the fan blade to the motor shaft.
9. Lock the fan blade by turning the spinner in an anticlockwise direction.
10. Hold the front guard with the logo in an upright position. Fix the plastic hook on the rear guard as shown. Secure the two guards properly with the guard clip to avoid the front guard from falling down.

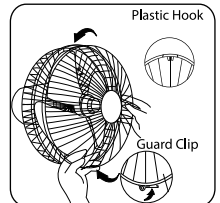
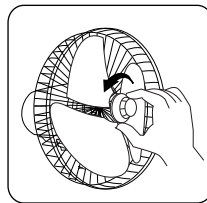
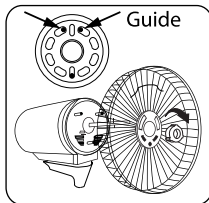
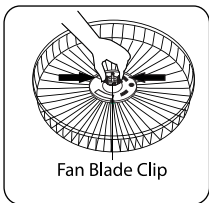

11. To dismantle, use one hand to hold the plastic pedestal and the other hand to hold the fan body as shown. Pull both hands in opposite direction to separate the plastic pedestal and fan body.

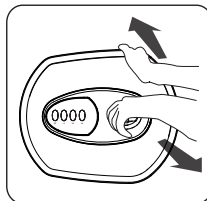

## How to use

- Press or lift the oscillation knob to start or stop the fan oscillation.
- Press the ON/OFF button to turn on the appliance.
- Press the Speed button to adjust between the 4 speeds.
- To adjust the appliance for vertical oscillation, rasp the main body, holding the handle and adjust up and down.
- To adjust the appliance horizontally, hold the hand to adjust the left and right oscillation.

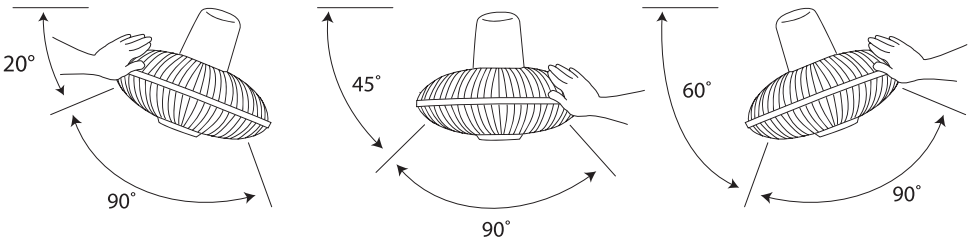

## CLEANING AND MAINTENANCE

### Cleaning

- Before cleaning and maintaining this appliance, be sure to pull out the plug and wait for the appliance body to cool down before cleaning.
- Do not use chemical solvents such as toluene, bleach, hard brushes, etc., to avoid scratching and corroding the appearance of the body. If there is stains or dirt that is not easy to fall off, it is recommended to use a neutral detergent for tableware to clean.
- When cleaning the body, please wipe it with a soft cloth dipped in a neutral detergent, and then wipe the remaining detergent with a dry cloth.

### Maintenance

- The front and rear nets and fan blades can be disassembled in the reverse order of assembly. Wipe them with a soft cloth dampened in water or a neutral detergent. After wiping them clean, wipe them thoroughly with a soft dry cloth.
- Do not rinse the body directly with water to prevent short circuit or poor conduction of the electrical appliance.
- If the appliance is not in use for a long time, please wipe it clean and cover it with a plastic bag, and store it in a cool and dry place.
- Before taking the appliance out and using it, please check whether the appliance and the power cord are damaged, and clean the dust on the appliance. After the check is completed, please carry out a test run. If there is no fault, it can be used normally.

## TROUBLESHOOTING

Problem	Cause of Issue	Solution
The blade does not rotate when pressing the power button to start.	The power cord is not plugged in.	Be sure to check that the power cord is properly plugged into the power socket
	The guard is deformed and hit the blade.	Check the guard and replace it if deformed
The blade rotates but there are abnormal sounds.	The guard is deformed and hit the blade	Check the guard and replace it if deformed
	The blade and/or guard is installed incorrectly	Check the blade and/or guard, and reinstall